

Creative Space®

150 N Myers St
Boyle Heights Industrial Flats

Three Industrial Warehouse Suites
Combinable up to ±75,652 RSF

For Lease



Contact
Tel 323 469 1734
Info@creativespace.us
DRE Lic #01976626

Located in the industrial flats section of Boyle Heights, 150 N Myers St is an industrial building featuring three (3) available suites ranging in size and combinable for a total of ±75,652 RSF.

Space	Type	RSF	Rate/SF/MO
121 N Mission	Industrial / Warehouse	±19,463	\$1.20 MG
150 N Myers St	Industrial / Warehouse	±45,909	\$1.50 MG
147 N Mission St	Industrial / Warehouse	±10,288	\$1.50 MG

Term: 3 to 5 Years + Options
Occupancy: January 2020

Features of 150 N Myers St Include

- Easy access to 5 major freeways
- On-site and street parking
- Close to Pico/Aliso Gold Line Station

Other Details

Parking: 34 on-site, plus ample street parking
Docks: 8 high loading positions
Ceiling Heights: Approx. 18' to 24' clear
Fire Safety: Full sprinkler system
Power: 8,000 amps / 3-phase
Construction: Concrete Tilt Up (CTU)



150 N Myers St has a mezzanine. See the floor plan on the following page.

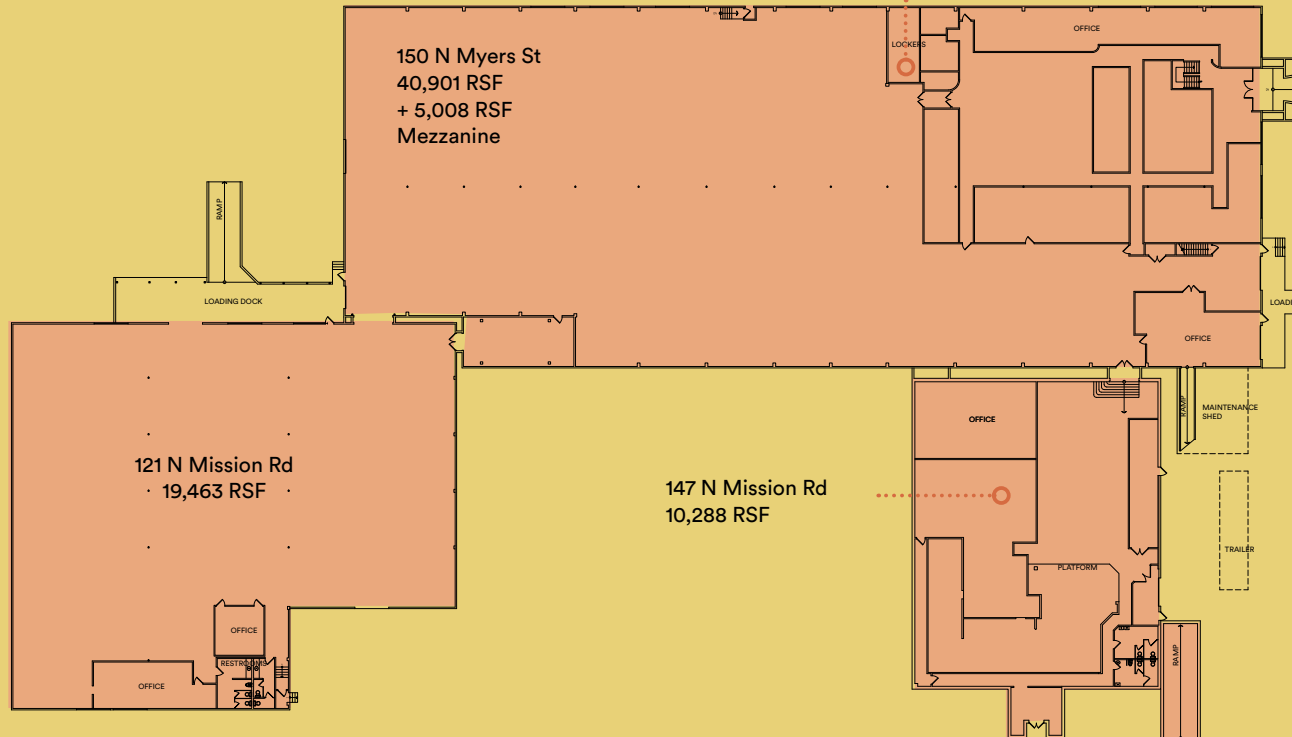

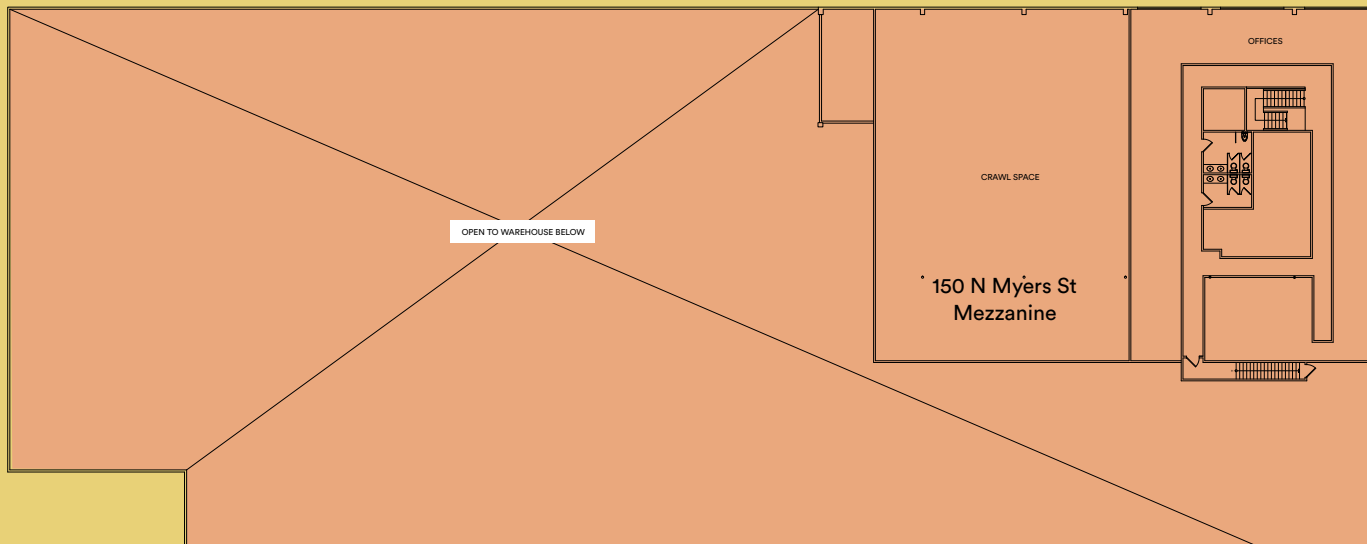



You Are Here
at 150 N Myers St



To request more information
or to schedule a viewing,
please contact us, Thank you.

Geoffrey Anenberg
geoffrey@creativespace.us
Tel 323 243 2821
DRE #01831214

Tyler Stonebreaker
tyler@creativespace.us
Tel 310 310 5408
DRE #01328468